



Access Control PSUs

Product Selector Tool



GET STARTED

Introduction



This tool has been created to assist you in finding the right Elmdene Power Supply based on making simple choices to guide you to the most applicable product range.

If you cannot find what you are looking for please contact Technical Support: 02392 696 638 – option 3

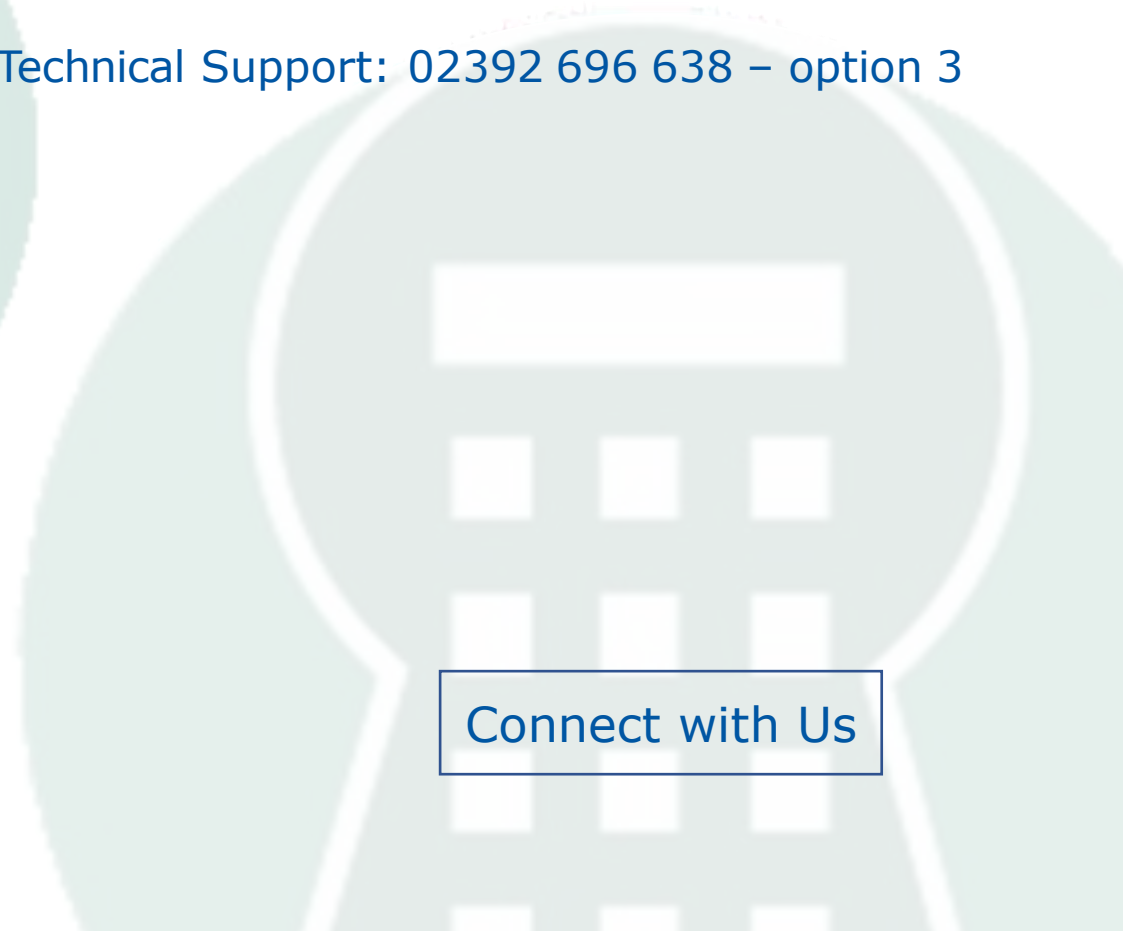
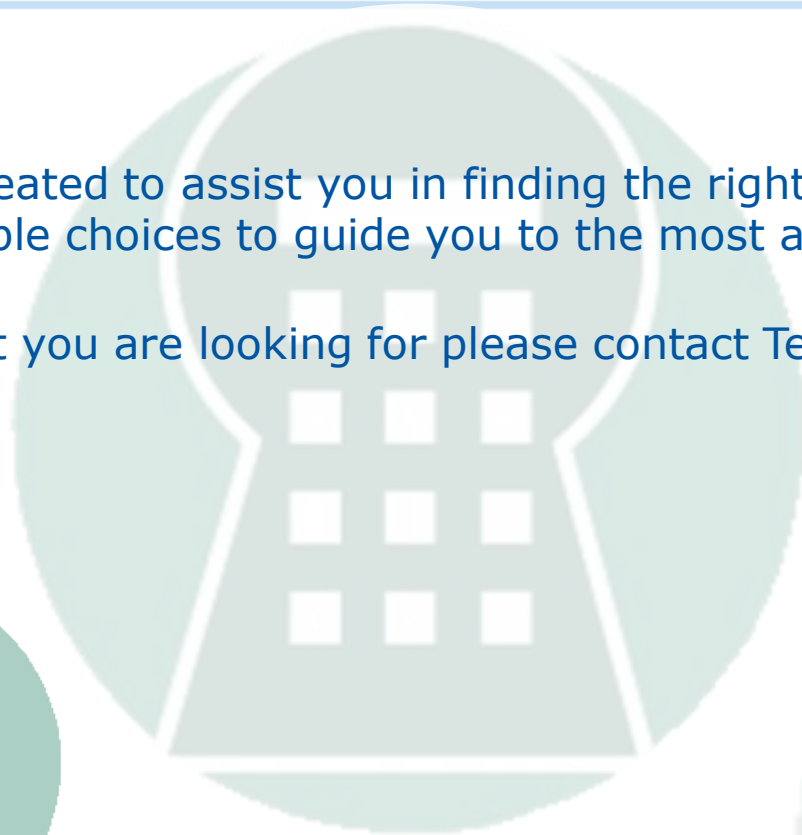

Next

Connect with Us

Access Control Power Supplies



Multi-Controller Solutions

12V NEDAP

12V Paxton

12V Salto

12V Access

FR Access Control (NEW!)

Battery Charging Only

12V
(G Range N Series)

12V BOXED

12V UNBOXED

24V
(G Range N Series)

Battery Charging Protection & Mains Fail Signalling

12V
(G Range BM Series)

12V BOXED

12V UNBOXED

24V
(G Range BM Series)

Selectable Solution

12-24V
Selectable PSUs

PoE Solution

PoE UltraPod



Connect with Us

Access Control: Multi-Controller Solutions



12 Volt NEDAP

Controllers	Qty	Part Code	Description	Size HxWxD	Max Battery
AP7003 AP7031 AP7803	1	ACCESS-PSU	13.8Vdc, 2A BM SMPSU Mains & Battery Monitoring	275 x 330 x 80	1x12V 7Ah
AP7003 AP7031 AP7803	2	ACCESS-PSU1	13.8Vdc, 4A BM SMPSU Mains & Battery Monitoring 4 way fused output module	355 x 362 x 85	1x12V 17Ah
AP7003 AP7031 AP7803	3	ACCESS-PSU2	13.8Vdc, 4A BM SMPSU Mains & Battery Monitoring 4 way fused output module	355 x 362 x 85	1x12V 17Ah
AP7003 AP7031 AP7803	3	ACCESS-PSU2-8A	13.8Vdc, 8A SMPSU Mains Monitoring 4 way fused output module	500 x 400 x 80	1x12V 17Ah

[Datasheet](#)

12V Paxton

12V Salto

12V Access

FR Access
Control (NEW!)



ACCESS-PSU2-8A



[Home](#)



Access Control: Multi-Controller Solutions



12 Volt Paxton

Controllers	Qty	Part Code	Description	Size HxWxD	Max Battery
Net2 Plus Net2 I/O Net2 Classic	1	ACCESS-PSU-N	13.8Vdc, 2A N-Range SMPSU	275 x 330 x 80	1x12V 17Ah
Net2 Plus Net2 I/O Net2 C6 Classic	1	ACCESS-PSU	13.8Vdc, 2A BM SMPSU Mains & Battery Monitoring	275 x 330 x 80	1x12V 7Ah
Net2 Plus Net2 I/O Net2 Classic	2	ACCESS-PSU1	13.8Vdc, 4A BM SMPSU Mains & Battery Monitoring 4 way fused output module	355 x 362 x 85	1x12V 17Ah
Net2 Plus Net2 I/O Net2 Classic	4	ACCESS-PSU2	13.8Vdc, 4A BM SMPSU Mains & Battery Monitoring 4 way fused output module	500 x 400 x 80	1x12V 17 Ah
Net2 Plus Net2 I/O Net2 Classic	4	ACCESS-PSU2-8A	13.8Vdc, 8A SMPSU Mains Monitoring 4 way fused output module	500 x 400 x 80	1x12V 17Ah

[Datasheet](#)

12V NEDAP

12V Salto

12V Access

FR Access Control (NEW!)



[Home](#)



ACCESS-PSU2-8A

Access Control: Multi-Controller Solutions



12 Volt Salto

Controllers	Qty	Part Code	Description	Size HxWxD	Max Battery
XS4 2.0 CV4200 CV505VN	1	ACCESS-PSU-N	13.8Vdc, 2A N-Range SMPSU	275 x 330 x 80	1x12V 17Ah
XS4 2.0 CV4200 CV505VN	1	ACCESS-PSU	13.8Vdc, 2A BM SMPSU Mains & Battery Monitoring	275 x 330 x 80	1x12V 7Ah
XS4 2.0 CV4200 CV505VN	2	ACCESS-PSU2	13.8Vdc, 4A BM SMPSU Mains & Battery Monitoring 4 way fused output module	500 x 400 x 80	1x12V 17Ah
XS4 2.0 CV4200 CV505VN	2	ACCESS-PSU2-8A	13.8Vdc, 8A SMPSU Mains Monitoring 4 way fused output module	500 x 400 x 80	1x12V 17Ah

[Datasheet](#)

12V NEDAP

12V Paxton

12V Access

FR Access
Control (NEW!)



ACCESS-PSU2-8A



[Home](#)



Access Control: Multi-Controller Solutions



12 Volt Access Range

Part Number	Rating	Battery	Box HxWxD
ACCESS-PSU-N	1 x 2A	17Ah	275 x 330 x 80 - hinge lid
ACCESS-PSU	1 x 2A	7Ah	275 x 220 x 80 - hinge lid
ACCESS-PSU1	4 x 1A	17Ah	355 x 362 x 85 - hinge lid
ACCESS-PSU2	4 x 1A	17Ah	500 x 400 x 80 - hinge lid
ACCESS-PSU2-8A	4 x 2A	17AH	500 x 400 x 80 - hinge lid

[Datasheet](#)

These power supplies have been specifically designed to house common access control boards/modules e.g. ACT, Paxton etc. and are capable of accommodating from 1 to 4 boards, dependent on model.

12V NEDAP

12V Paxton

12V Salto

FR Access Control (NEW!)



ACCESS-PSU2-8A



[Home](#)



Access Control: Multi-Controller Solutions



12 Volt FR Access Control *NEW!*

Part Number	Rating	Battery	Description	Box HxWxD
ALIM-ACCES-1-5A	4A	7Ah	4-way Fused Output Modules	330 x 355 x 80
ALIM-ACCES-2-8A	8A	17Ah	4-way Fused Output Modules	500 x 400 x 80
ALIM-ACCES-5-8A	8A	17Ah	4-way Fused Output Modules	515 x 478 x 146

[Datasheet](#)

[12V NEDAP](#)

[12V Paxton](#)

[12V Salto](#)

[12V Access](#)

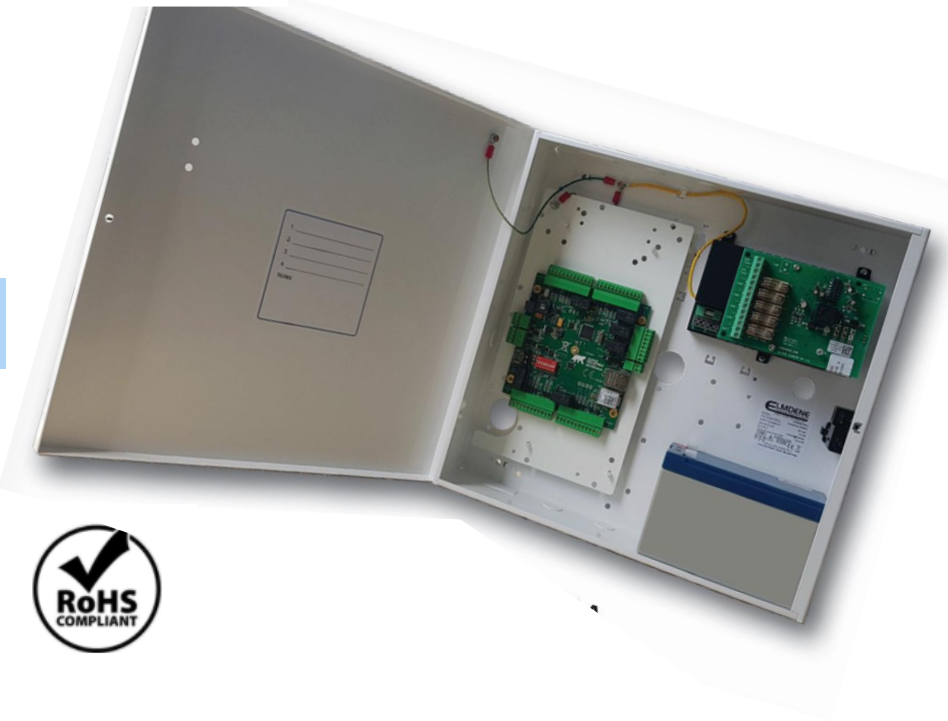

[Home](#)



Access Control: Battery Charging Only



12 Volt G Range N Series (Metal Boxed)

*Accommodates Paxton Net2 Plus Controller

Part Number	Rating	Battery	Box HxWxD
G13801N-A	1A	7Ah	200 x 230 x 80 - hinge lid
G13801N-B	1A	17Ah	330 x 355 x 80 - clam lid
G13801N-C	1A	17Ah	275 x 330 x 80 - hinge lid
G13802N-A	2A	7Ah	200 x 230 x 80 - hinge lid
G13802N-B	2A	17Ah	330 x 355 x 80 - clam lid
G13802N-C*	2A	17Ah	275 x 330 x 80 - hinge lid
G13803N-A	3A	7Ah	200 x 230 x 80 - hinge lid
G13803N-B	3A	17Ah	330 x 355 x 80 - clam lid
G13803N-C	3A	17Ah	275 x 330 x 80 - hinge lid
G13804N-B	4A	17Ah	330 x 355 x 80 - clam lid
G13804N-C		17Ah	275 x 330 x 80 - hinge lid
G13804N-4-C	4 x 1A	17Ah	275 x 330 x 80 - hinge lid
G13805N-B	5A	17Ah	330 x 355 x 80 - clam lid
G13805N-C	5A	17Ah	275 x 330 x 80 - hinge lid

Datasheet

12V UNBOXED

24V
(G Range N Series)



Home

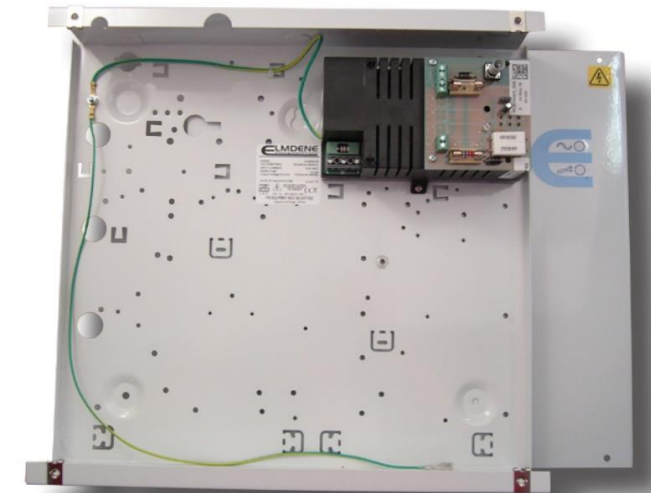

G13805N-B

Access Control: Battery Charging Only



12 Volt G Range N Series (Unboxed)

Part Number	Rating	Battery	Dims HxWxD
G13801NU	1A	7-17Ah	134 x 84 x 42
G13802NU	2A	7-17Ah	134 x 84 x 42
G13803NU	3A	7-17Ah	134 x 84 x 42
G13804NU	4A	17Ah	152 x 106 x 71
G13805NU	5A	17Ah	152 x 106 x 71

Datasheet

12V BOXED

24V
(G Range N Series)



Home

Access Control: Battery Charging Only



24 Volt G Range N Series (Metal Boxed)

Part Number	Rating	Battery	Box HxWxD
G2401N-C	1A	2x7Ah	275x330x80 – hinge lid
G2401N-R	1A	2x17Ah	410x390x90 – clam lid
G2402N-C	2A	2x7Ah	275x330x80 – hinge lid
G2402N-R	2A	2x17Ah	410x390x90 – clam lid
G2403N-C	3A	2x7Ah	275x330x80 – hinge lid
G2403N-R	3A	2x17Ah	410x390x90 – clam lid
G2405N-C	5A	2x7Ah	275x330x80 – hinge lid
G2405N-R	5A	2x17Ah	410x390x90 – clam lid
G2405N-H	5A	2x38Ah	420x420x180 – hinge lid

[Datasheet](#)

[12V BOXED](#)

[12V UNBOXED](#)



[Home](#)

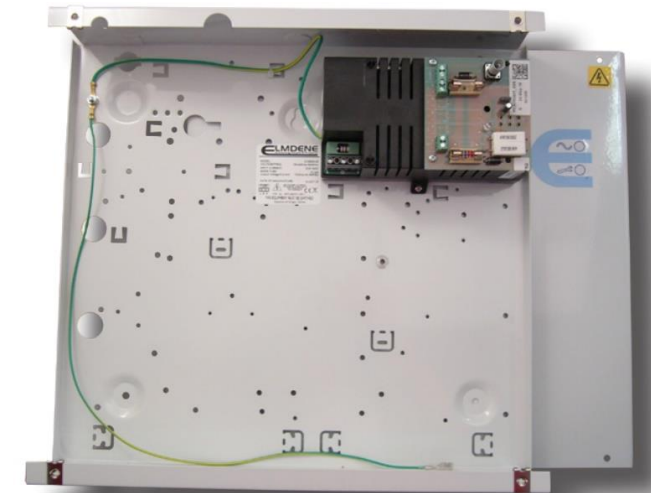

G13805N-B

Access Control: Battery Charging, Protection & Mains Fail Signalling



12 Volt G Range BM Series (Metal Boxed)

Part Number	Rating	Battery	Box HxWxD
G13801BM-A	1A	7Ah	200 x 230 x 80 - hinge lid
G13801BM-B	1A	17Ah	330 x 355 x 80 - clam lid
G13801BM-C	1A	17Ah	275 x 330 x 80 - hinge lid
G13802BM-A	2A	7Ah	200 x 230 x 80 - hinge lid
G13802BM-B	2A	17Ah	330 x 355 x 80 - clam lid
G13802BM-C	2A	17Ah	275 x 330 x 80 - hinge lid
G13803BM-B	3A	17Ah	330 x 355 x 80 - clam lid
G13803BM-C	3A	17Ah	275 x 330 x 80 - hinge lid
G13804BM-B	4A	17Ah	330 x 355 x 80 - clam lid
G13804BM-C	4A	17Ah	275 x 330 x 80 - hinge lid
G13805BM-B	5A	17Ah	330 x 355 x 80 - clam lid
G13805BM-C	5A	17Ah	275 x 330 x 80 - hinge lid
G13810BM-8-C	10A (2x5A modules)	2x7Ah	275 x 330 x 80 - hinge lid
G13810BM-8-R	10A (2x5A modules)	2x17Ah	410 x 390 x 80 - hinge lid

Datasheet

12V UNBOXED

24V
(G Range BM Series)

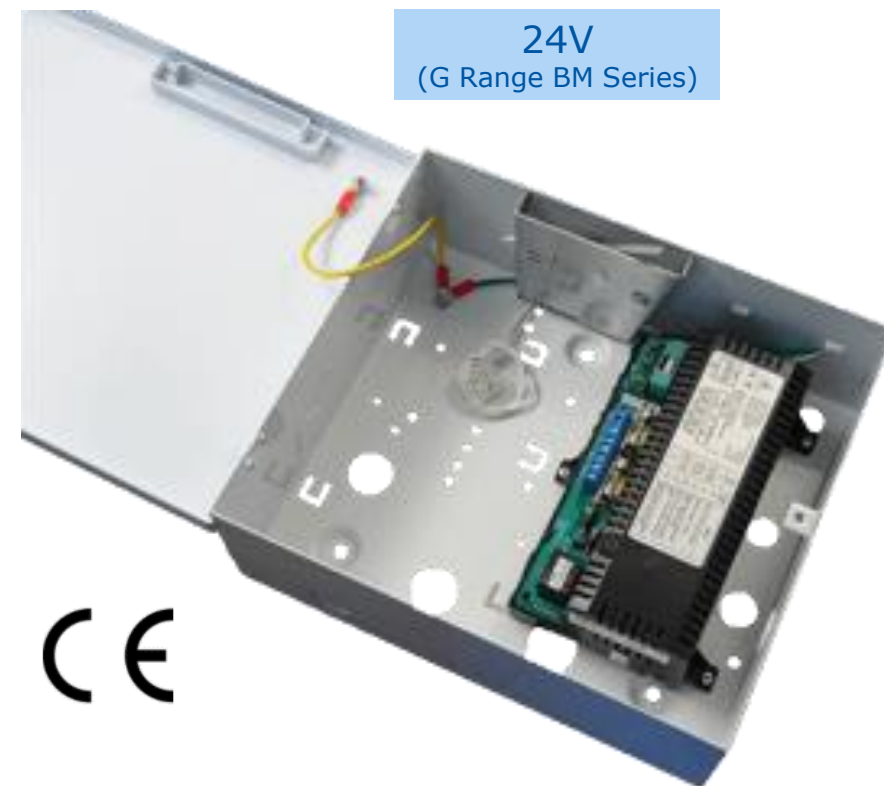

Home

Access Control: Battery Charging, Protection & Mains Fail Signalling



12 Volt G Range BM Series (Unboxed)

Part Number	Rating	Battery	Dims HxWxD
G13801BMU	1A	7Ah	152 x 106 x 52
G13802BMU	2A	7Ah	152 x 106 x 52
G13803BMU	3A	17Ah	152 x 106 x 71
G13804BMU	4A	17Ah	152 x 106 x 71
G13805BMU	5A	17Ah	152 x 106 x 71

[Datasheet](#)

12V BOXED

24V
(G Range BM Series)

Battery size is typical for given psu and will recharge in approximately 24 – 36 hours, larger batteries may be fitted if space allows but will take longer to recharge.

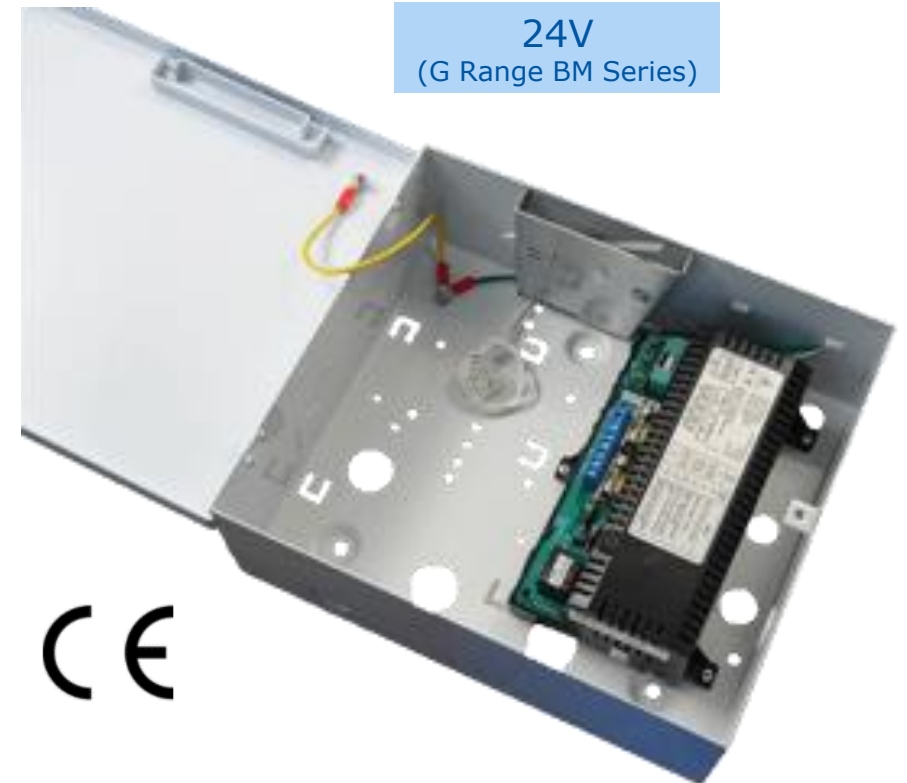

[Home](#)

Access Control: Battery Charging, Protection & Mains Fail Signalling



24 Volt G Range BM Series (Metal Boxed)

Part Number	Rating	Battery	Box HxWxD
G2401BM-C	1A	2x7Ah	275 x 330 x 80 - hinge lid
G2401BM-R	1A	2x17Ah	410 x 390 x 90 - clam lid
G2402BM-C	2A	2x7Ah	275 x 330 x 80 - hinge lid
G2402BM-R	2A	2x17Ah	410 x 390 x 90 - clam lid
G2403BM-C	3A	2x7Ah	275 x 330 x 80 - hinge lid
G2403BM-R	3A	2x17Ah	410 x 390 x 90 - clam lid
G2405BM-C	5A	2x7Ah	275 x 330 x 80 - hinge lid
G2405BM-R	5A	2x17Ah	410 x 390 x 90 - clam lid
G2405BM-H	5A	2x38Ah	420 x 420 x 180 - hinge lid
G2410BM-E	10A	2x17Ah	420 x 400 x 80 - hinge lid

Datasheet

12V
(G Range BM Series)

12V BOXED

12V UNBOXED

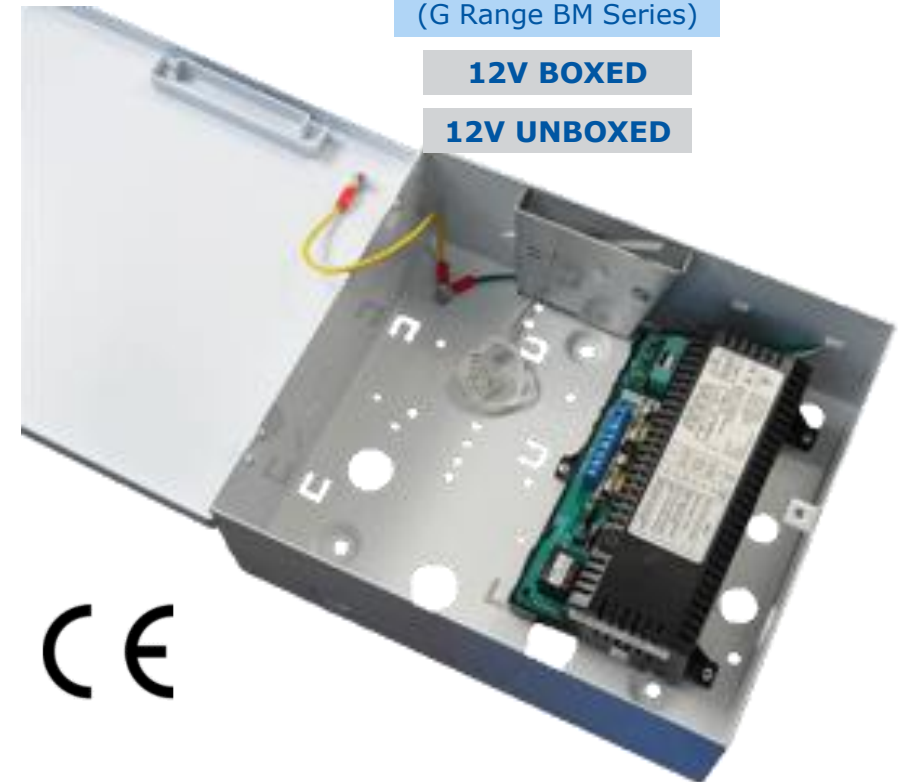

Home

Access Control: Selectable 12-24V



12-24 Volt Selectable

Part Number	Rating	Battery	Box / Module
G1224-42N-C	12V, 4A / 24V, 2A	1 or 2 x 7Ah	Box 275 x 330 x 80
G1224-42NU	12V,4A / 24V, 2A	1 or 2 x 7Ah	Module 152 x 106 x 52
G1224-63N-C	12V,6A / 24V, 3A	1 or 2 x 7Ah	Box 275 x 330 x 80
G1224-63N-R	12V,6A / 24V, 3A	1 or 2 x 17Ah	Box 410 x 390 x 80
G1224-63NU	12V,6A / 24V, 3A	1 or 2 x 7Ah	Module 157 x 143 x 55
G1224-84N-C	12V,6A / 24V, 4A	1 or 2 x 7Ah	Box 275 x 330 x 80
G1224-84N-H	12V,6A / 24V, 4A	1 or 2 x 17Ah	Box 420 x 420x 180
G1224-84N-R	12V,6A / 24V, 4A	1 or 2 x 17Ah	Box 410 x 390 x 80
G1224-84N-4-C	12V,8A / 24V, 4A - 4 x fused outputs	1 or 2 x 7Ah	Box 275 x 330 x 80
G1224-84N-4-R	12V,8A / 24V, 4A - 4 x fused outputs	1 or 2 x 17Ah	Box 410 x 390 x 80
G1224-84N-8-C	12V,8A / 24V, 4A - 8 x fused outputs	1 or 2 x 7Ah	Box 275 x 330 x 80
G1224-84N-8-R	12V,8A / 24V, 4A - 8 x fused outputs	1 or 2 x 17Ah	Box 410 x 390 x 80
G1224-84NU	12V, 8A / 24V, 4A	1 or 2 x 7Ah	Module 157 x 143 x 55

[Datasheet](#)



This range of selectable PSUs allows the user to select either a 12V (13.8V) or 24V (27.6V) output. Typically used in Access Control applications but also suitable for use in CCTV and general purpose use.

This range features a Volt Free Mains Fail Relay Output and an Independent Ancillary Relay which can be used for applications such as a Fire door release relay.

The un-boxed unit battery size is typical for PSU and recharges in approximately 24 to 36 hours. Larger batteries may be fitted if space allows but will take longer to recharge.



[Home](#)

Access Control: PoE Solution



PoE Solution UltraPod

Part Number	Rating	Battery	Box
POE-ULTRA-POD-MOD	Up to 3A	1 x 17Ah	Module Only
POE-ULTRA-POD-B	Up to 3A	1 x 17Ah	330 x 355 x 80

[Datasheet](#)

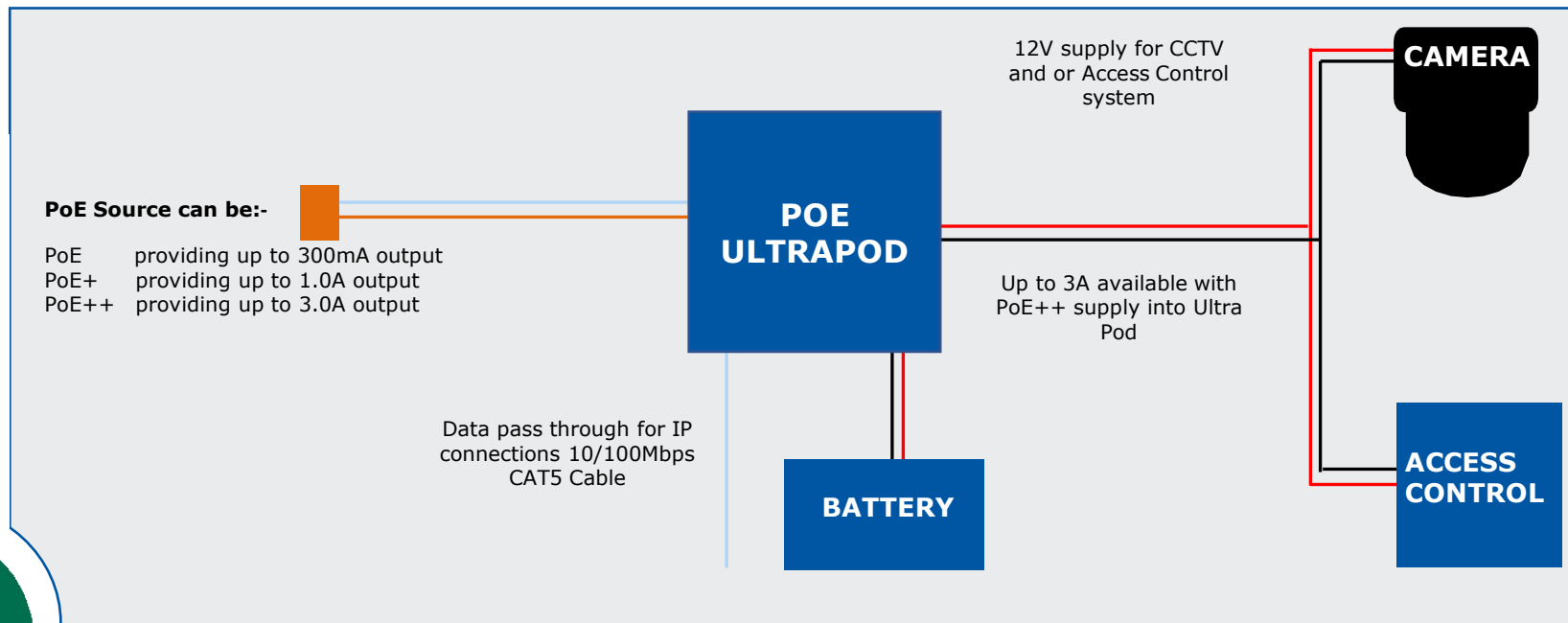

[Home](#)





Follow Elmdene and keep up-to-date with the latest news and product info:



a  POTTER company

Start Again